



BAHN SHIFT ARM FOR TOURING/TRIKE

1096

THANK YOU FOR CHOOSING KÜRYAKYN!

PROTECT YOURSELF AND OTHERS FROM POSSIBLE INJURY AND PROPERTY DAMAGE OR LOSS. PAY CLOSE ATTENTION TO ALL INSTRUCTIONS, WARNINGS, CAUTIONS, AND NOTICES REGARDING THE INSTALLATION, USE, AND CARE OF THIS PRODUCT.

WARNING

THIS INDICATION ALERTS YOU TO THE FACT THAT IGNORING THE CONTENTS DESCRIBED HEREIN CAN RESULT IN POTENTIAL DEATH OR SERIOUS INJURY.

CAUTION

This indication alerts you to the fact that ignoring the contents described herein can result in minor or moderate potential injury.

NOTICE

This indication alerts you to the fact that ignoring the contents described herein may negatively affect product performance and functionality or damage the product itself or the product to which it is being attached.

MAKE SURE THE FOLLOWING PARTS HAVE BEEN INCLUDED IN THE KIT:

- 1 BAHN Shift Arm
- 1 Installation instructions

TOOLS SUGGESTED:

Set of combination wrenches, set of hex wrenches, masking tape and marker, in-lbs and ft-lbs torque wrenches

NOTICE

These installation instructions contain important information. Ensure that the end user receives this copy and is aware of its importance for future reference.

STEP 1

Read and understand all steps in the instructions before starting the installation. Park the motorcycle on a hard, level surface and turn off the ignition. Allow the engine and exhaust system to cool. REMOVE THE MAIN FUSE.

WARNING

YOU WILL BE WORKING AROUND THE ENGINE AND EXHAUST SYSTEM DURING INSTALLATION. ENSURE THAT THE ENGINE AND EXHAUST SYSTEM HAVE FULLY COOLED TO PREVENT INJURY.

WARNING

ACCIDENTAL VEHICLE START-UP COULD CAUSE DEATH OR SERIOUS INJURY, REMOVE THE MAIN FUSE BEFORE PROCEEDING.

CUSTOMER SERVICE

877.370.3604 (toll free)

INSTALLATION QUESTIONS

techsupport@kuryakyn.com
or call 715.247.2983

LIMITED WARRANTY

Kuryakyn warrants that any Kuryakyn products sold hereunder, shall be free of defects in materials and workmanship for a period of one (1) year from the date of purchase by the consumer excepting the following provisions:

- Kuryakyn shall have no obligation in the event the customer is unable to provide a receipt showing the date the customer purchased the product(s).
- The product must be properly installed, maintained and operated under normal conditions.
- Kuryakyn makes no warranty, expressed or implied, with respect to any gold plated products.
- Kuryakyn shall not be liable for any consequential and incidental damages, including labor and paint, resulting from failure of a Kuryakyn product, failure to deliver, delay in delivery, delivery in nonconforming condition, or for any breach of contract or duty between Kuryakyn and a customer.
- Kuryakyn products are often intended for use in specific applications. Kuryakyn makes no warranty if a Kuryakyn product is used in applications other than intended.
- Kuryakyn electrical products are warranted for one (1) year from the date of purchase by the consumer. L.E.D.'S contained in components of Kuryakyn products will be warranted for defects in materials and workmanship for 3 years from the date of purchase where as all other components shall be warranted for one(1) year. This includes, but is not limited to; control modules, wiring, chrome & other components.
- Kuryakyn makes no warranty of any kind in regard to other manufacturer's products distributed by Kuryakyn. Kuryakyn will pass on all warranties made by the manufacturer and where possible, will expedite the claim on behalf of the customer, but ultimately, responsibility for disposition of the warranty claim lies with the manufacturer.

ABOUT OUR CATALOG

For purchasing Kuryakyn® products, you can receive a complete catalog free of charge. Send the Proof-of-Purchase below with your address to: Kuryakyn
454 County Road V V
Somerset, WI 54025-9031
Please indicate either Accessories Catalog for Harley-Davidson® or GL & Metric Cruisers.

Be sure to ask your local dealer about other Kuryakyn® products, the motorcycle parts and accessories designed for riders by riders.

©2005 Kuryakyn USA® All Rights reserved.



kuryakyn.com



Working around the sharp edges of the cylinder-head fins exposes your hands to injury. Wear protective gloves to prevent serious injury.

Küryakyn®

STEP 2 Place one piece of tape on the transmission case and one on the shift lever assembly. Use a marker to mark the position of the existing shift arm as shown in **PIC 1 (green arrow)**.

STEP 3 Refer to **PIC 1 (yellow arrow)**. Remove the screw from the lower front of the existing shift arm.

STEP 4 Refer to **PIC 1 (orange arrow)**. Detach the shift linkage from the existing shift arm; remove the nut, lock washer and flat washer (not shown). Set the hardware aside for now, it will be reused later.

STEP 5 Slide the existing shift arm off of the shift shaft; set it aside, it will not be reused.

STEP 6 Refer to **PIC 2**. Rotate the BAHN Shift Arm until it aligns with the Heim joint stud; loosely secure the shift linkage to the Arm with the flat washer, lock washer and nut from **STEP 4**.

STEP 7 Refer to **PIC 3**. Rotate the shift lever assembly to align the marks on the tape; slide the BAHN Shift Arm onto the splines of the shift shaft.

STEP 8 Align the screw hole in the BAHN Shift Arm with the groove in the shift shaft; insert the screw from **STEP 3**.

NOTE:

If the screw hole and groove in the shift shaft are not aligned, you will not be able to correctly install the screw from **STEP 3**.

Loosen the existing shift lever pinch screw(s) to align the shift shaft groove and BAHN Shift Arm hole.

STEP 9 Once the socket head screw has been installed in the BAHN Shift Arm, **torque it to 90-110 in-lbs (10.2-12.4 Nm)**.

If necessary, tighten the shift lever pinch screws, then **torque to 18-22 in-lbs (24.4-29.8 Nm)**.

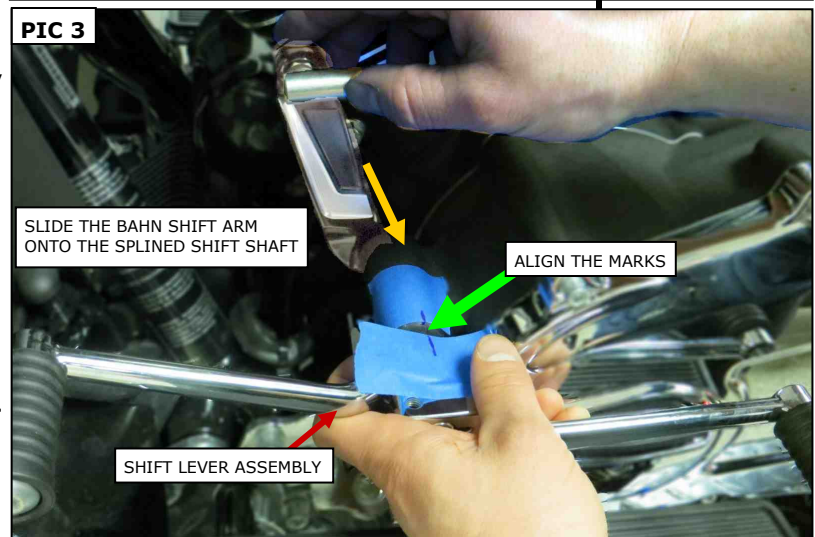
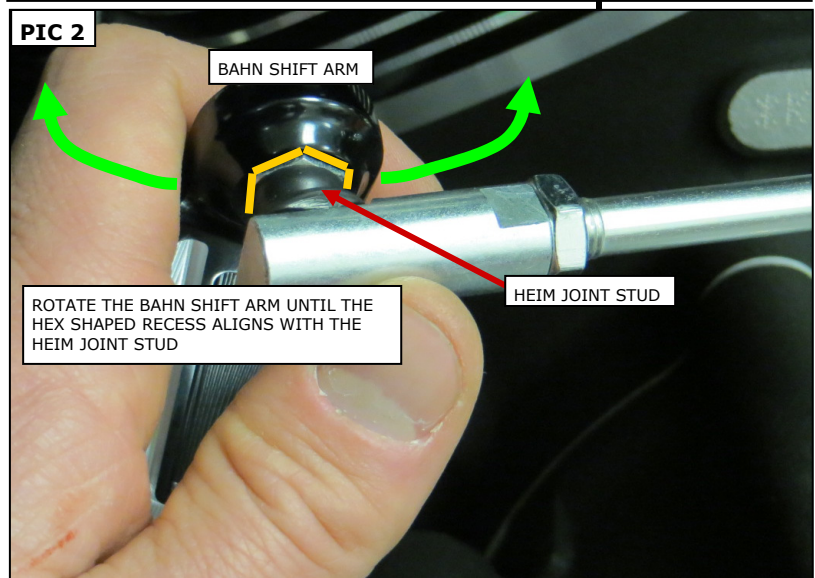
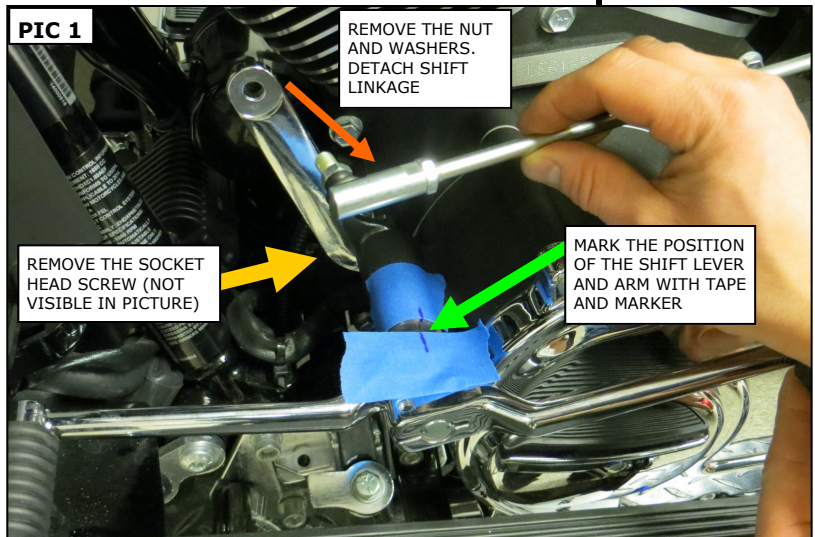

- STEP 10** Secure the shift lever assembly (so it does not shift the bike into gear) and tighten the nut on the back side of the BAHN Shift Arm.
- STEP 11** Remove and discard the tape.
- STEP 12** Reinstall the main fuse.
- STEP 13** Ensure that the entire shifter mechanism functions properly and does not interfere with the safe operation of the motorcycle **BEFORE** start-up.

⚠ WARNING

DURING THE INSTALLATION OF THIS PRODUCT, THE VEHICLE MAY BE SHIFTED INTO GEAR. STARTING THE VEHICLE WHILE IN GEAR CAN CAUSE SUDDEN VEHICLE MOVEMENT RESULTING IN SERIOUS INJURY OR DEATH. ENSURE THE VEHICLE IS NOT IN GEAR **BEFORE START-UP.**

NOTICE

If further shifter adjustment is necessary, consult the service manual for your specific model of motorcycle.

NOTICE

It is the end user's responsibility to ensure that all of the fasteners (including pre-assembled) are tightened before operation of the motorcycle. Küryakyn will not provide warranty coverage on products or components lost due to improper installation or lack of maintenance. Periodic inspection and maintenance are required on all fasteners.

TIPS FOR PROPER CARE:

Your new BAHN product is made out of anodized aluminum. Anodized aluminum requires special attention when cleaning. Some cleaning products or procedures can actually remove the anodized treatment which will lead to pitting in the aluminum.

Thoroughly clean the BAHN product often with a soft cloth, mild soap and water. Regular cleaning keeps contaminants from building up.

Rinse thoroughly with FRESH water.

Use only metal protection products that are formulated for anodized aluminum.

DO NOT USE bleach or chlorides to clean the BAHN product.

DO NOT USE products containing abrasives to clean the BAHN product. **Never** use steel or brass wool, wire brushes, polishing wheels, rubbing or polishing compounds on the BAHN product.

DO NOT USE concentrated alkaline based solutions to clean the BAHN product. Many detergents are alkaline based.

Ride On!